



NON-SPILLABLE SEALED RECHARGEABLE BATTERY

TY-FT12-50

☆ SPECIFICATION	☆ CHARACTERISTICS
● NOMINAL VOLTAGE : 12 V	● CAPACITY 25°C / 77°F
● NOMINAL CAPACITY(10 hrs) : 50 Ah	10 hr @ 5 A : 50 Ah
● DIMENSIONS	5 hr @ 8 A : 40 Ah
TOTAL HEIGHT : 222 mm (8.7 inches)	3 hr @ 12.5 A : 37.5 Ah
CONTAINER HEIGHT : 222 mm (8.7 inches)	1 hr @ 30 A : 30 Ah
LENGTH : 277 mm (10.9 inches)	1 C @ 50 A : 25Ah
WIDTH : 106 mm (4.2 inches)	● INTERNAL RESISTANCE(25°C , 77 °F) : 8 mΩ
WEIGHT : APPROX 17.5 kg (38.6 lbs)	● CHARGING VOLTAGE (25°C , 77 °F)
● MAX DISCHARGE CURRENT : 400A (5 sec)	STANDBY USE : 2.275±0.025 V/CELL
● MAX SHORT- DURATION DISCHARGE CURRENT : 1000 A(0.1 sec)	: (-3.3mV / °C / CELL)
● STANDARD TERMINALS : RECEPTACLE TERMINAL	CYCLE USE : 2.45±0.05 V/CELL
● CONTAINER MATERIAL : GENERAL GRADE ABS	: (-5 mV / °C / CELL)
● DESIGN LIFE FOR STANDBY USE AT 20°C(68°F): 10 YEARS	● MAX CHARGING CURRENT : 15 A

Discharge Characteristics 25 °C (77 °F)

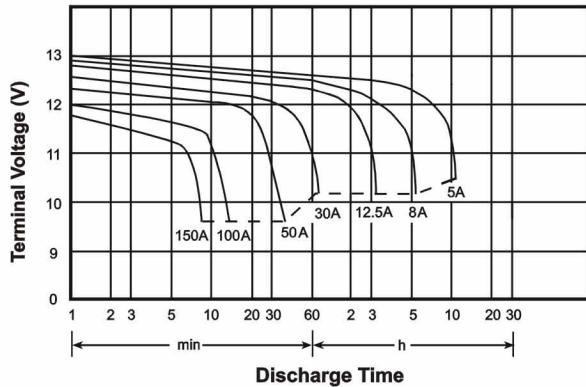

OPEN CIRCUIT VOLTAGE VS REMAINING CAPACITY

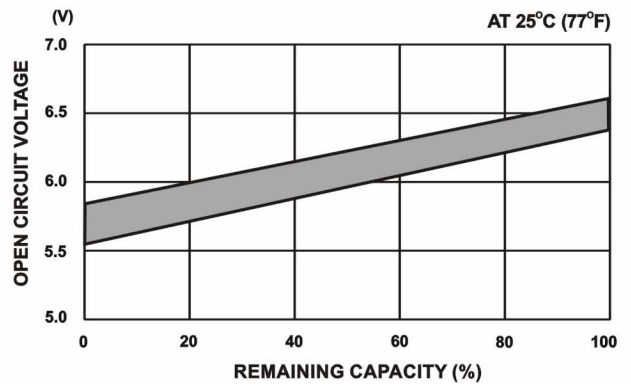

☆ Terminal

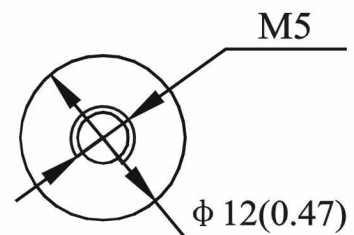

mm(inch)